

Tees

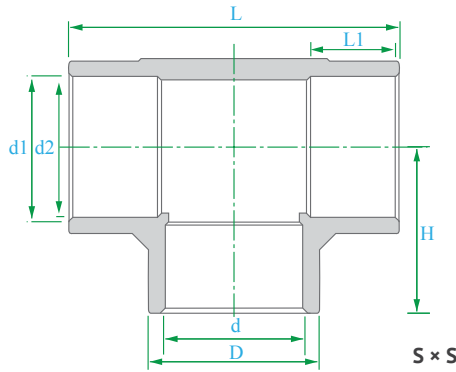

S x S

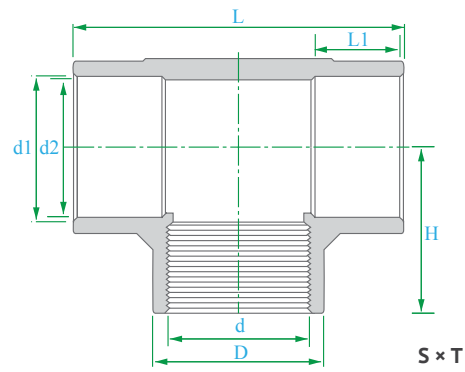

S x T

PART	NOMINAL SIZE	TEE - S x S	UNIT OF MEASURE: MM						APPROX. WT.
			D	d	d1	d2	L	L1	
0307.TEE.0050	1/2"	29.50	19.00	21.54	21.23	70.00	22.50	35.00	0.05
0307.TEE.0075	3/4"	35.00	24.00	26.87	26.57	80.00	25.50	40.00	0.07
0307.TEE.0100	1"	43.00	31.00	33.65	33.27	95.00	29.00	47.50	0.11
0307.TEE.0125	1 1/4"	52.50	40.00	42.42	42.04	112.00	32.00	55.00	0.17
0307.TEE.0150	1 1/2"	59.00	46.00	48.56	48.11	124.00	35.00	62.00	0.22
0307.TEE.0200	2"	72.00	58.00	60.63	60.17	143.00	38.50	71.50	0.34
0307.TEE.0250	2 1/2"	87.50	70.00	73.38	72.85	167.00	44.50	83.50	0.58
0307.TEE.0300	3"	105.00	86.00	89.31	88.70	190.00	48.00	95.00	0.86
0307.TEE.0400	4"	132.00	110.00	114.76	114.07	235.00	57.50	117.50	1.48
0307.TEE.0500	5"	-	-	-	-	-	-	-	3.20
0307.TEE.0600	6"	193.00	164.00	168.83	168.00	334.00	77.00	167.00	4.30
0307.TEE.0800	8"	245.00	214.00	219.84	218.70	448.00	100.00	224.00	8.00
0307.TEE.1000	10"	318.00	-	273.81	272.67	585.00	140.00	292.00	21.00
0307.TEE.1200	12"	356.00	-	324.61	323.47	672.00	160.00	338.00	29.00
0307.TEE.1400	14"	399.00	-	356.39	-	738.00	178.00	370.00	35.00
0307.TEE.1600	16"	450.00	-	407.19	-	866.00	204.00	433.00	38.00
0307.TEE.1800	18"	505.00	-	457.99	-	980.00	228.00	490.00	48.00
0307.TEE.2000	20"	563.00	-	517.07	-	1022.00	254.00	510.00	56.00
0307.TEE.2400	24"	674.00	-	611.58	-	1225.00	305.00	613.00	84.00

PART	NOMINAL SIZE	TEE - S x T	UNIT OF MEASURE: MM						APPROX. WT.
			D	d	d1	d2	L	L1	
0307.FTP.0050	1/2"	29.50	19.00	21.54	21.23	70.00	22.50	35.00	0.05
0307.FTP.0075	3/4"	35.00	24.00	26.87	26.57	80.00	25.50	40.00	0.07
0307.FTP.0100	1"	43.00	31.00	33.65	33.27	95.00	29.00	47.50	0.11
0307.FTP.0125	1 1/4"	52.50	40.00	42.42	42.04	112.00	32.00	55.00	0.17
0307.FTP.0150	1 1/2"	59.00	46.00	48.56	48.11	124.00	35.00	62.00	0.22
0307.FTP.0200	2"	72.00	58.00	60.63	60.17	143.00	38.50	71.50	0.34
0307.FTP.0250	2 1/2"	87.50	70.00	73.38	72.85	167.00	44.50	83.50	0.58
0307.FTP.0300	3"	105.00	86.00	89.31	88.70	190.00	48.00	95.00	0.86
0307.FTP.0400	4"	132.00	110.00	114.76	114.07	235.00	57.50	117.50	1.48

Notes: Physical dimensions and tolerances meet the requirements of ASTM Standard D-2467. PVC material meets ASTM Standard D-1784. Dimensions are subject to change without notice. Contact your HYDROSEAL representative for certification.